

9W LED Driver Constant current

LS-9-XXX TRIAC LI



■ Approve

SELV 

■ Features

- Class II, SELV, independent
- Input Voltage 220-240VAC
- Protections: SCP/OLP/OVP
- Power Factor >0.9
- Efficiency ≥78%
- Support Leading edge & trailing edge dimmable
- 5 years warranty

■ Applications(Typ.)

- LED panel
- LED pendant lights
- LED down lights

■ Description

LS-9-XXX TRIAC LI is a 9W constant current LED driver that operates from 198-264Vac input with 200mA to 500mA output current. With it's compact dimensions from 100 x 38 x 25mm it is easy to integrate in LED panel, pendant light and down light products. To ensure trouble-free operation, protection is provided against output short circuit and over Load.

■ Model code

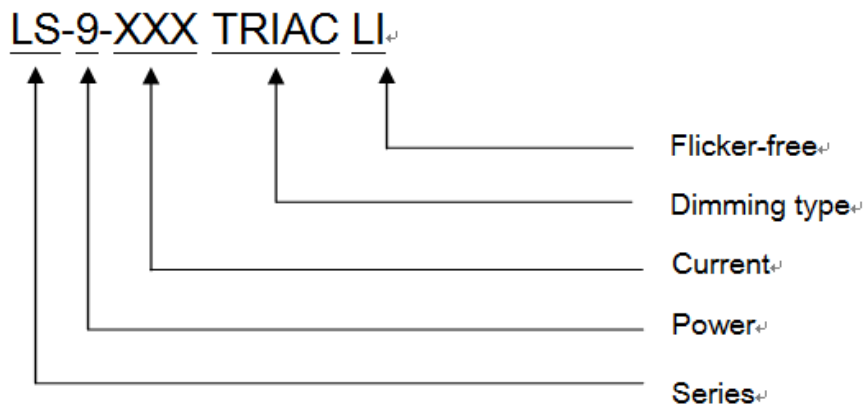

9W LED Driver Constant current

LS-9-XXX TRIAC LI

■ Specification

Input	Rated input voltage	220-240Vac			
	Range of input voltage	198-264Vac			
	Frequency(Hz)	50/60 Hz			
	Power Factor	>0.9@230Vac, full load			
	Input Current max	0.08A MAX. @Full Load,198Vac			
	Start-up time	< 0.5S			
	Unload Power Consumption	≤1W			
	Inrush Current	10A Max. /60μs@230V, Full Load , 50%Ipk-50%Ipk			
	THD	< 25%@Full Load,230VAC			
	Leakage Current	< 0.5mA(240VAC)			
Output	Constant Current Max.	200mA	350mA	...	500mA
	Unload voltage Max. (VDC)	55V	35V	...	28V
	Voltage Range(VDC)	27-42V	17-27V	...	12-19V
	Rated power	8.4W Max.	9.5W Max.	...	9.5W Max
	Current Accuracy	±5%@220-240Vac (±7 for I _o ≤300mA)			
	Voltage Regulation	±5% @Full Load, 220-240Vac			
	Load Regulation	±5%@220-240Vac			
	Hold-up Time	1s max.@Full Load			
	Ripple & Noise *Note.2	≤±3% @Full Load,230VAC			
	Output LF current ripple(<120Hz)	≤±3% @Full Load,230VAC			
	Efficiency(Typ.)	≥78% @Full Load,230VAC			
Dimming	Dimming mode	Triac , Leading edge & trailing edge dimmable			
	Dimming current range	10% ~ 100%			
Protection	Over Load Protection	103-120% Protection type: Auto Resume			
	Over Voltage Protection	>55VDC	>35VDC	...	>28VDC
	Short circuit Protection	Protection type: Auto Resume			
Environment	Operating Temperature	-20°C...+50°C			
	tc	80°C			
	Storage Temperature	-25°C...+60°C			
	Life time	> 30,000h@ta=50°C			
	Humidity	20%-90%RH			
Others	Dimension	100X38X25(LXWXH)mm			
Safety & EMC	Safety standards	EN 61347-1; EN61347-2-13; EN62384			
	Withstand voltage	Input-output : 3750V/5mA/1min			
	Isolation resistance	Input-output : ≥4MΩ@500VDC			
	EMI	EN55015; EN61000-3-2 Class C; EN61000-3-3			
	EMS	EN 61547; EN 61000-4-2; EN 61000-4-5 —L-N: 500V			
Note	1.All parameters NOT specially mentioned are measured at 230VAC input, full load and 25°C of ambient temperature. 2.Ripple & Noise are measured at 20MHz of bandwidth by using a 300mm twisted pair-wire terminated with a 0.1μF & 47 μF parallel capacitor. 3.Output current can be from 200mA to 500mA and increasing in multiples of 50mA. Please see Model list below and contact EAGLERISE for details.				

9W LED Driver Constant current

LS-9-XXX TRIAC LI

Model list

No	Model number	Input			Output			Max. Prated(W)
		Voltage (VAC)	Max.Current (A)	Frequency (Hz)	Constant current (mA)	Normal working voltage (VDC)	No load working voltage (VDC)	
1	LS-9-200 TRIAC LI	220-240	0.08	50/60	200	27-42	55	8.4
2	LS-9-250 TRIAC LI	220-240	0.08	50/60	250	25-38	50	9.5
3	LS-9-300 TRIAC LI	220-240	0.08	50/60	300	20-30	40	9
4	LS-9-350 TRIAC LI	220-240	0.08	50/60	350	17-27	35	9.5
5	LS-9-400 TRIAC LI	220-240	0.08	50/60	400	15-23	33	9.2
6	LS-9-450 TRIAC LI	220-240	0.08	50/60	450	13-20	30	9
7	LS-9-500 TRIAC LI	220-240	0.08	50/60	500	12-19	28	9.5

Wiring diagram

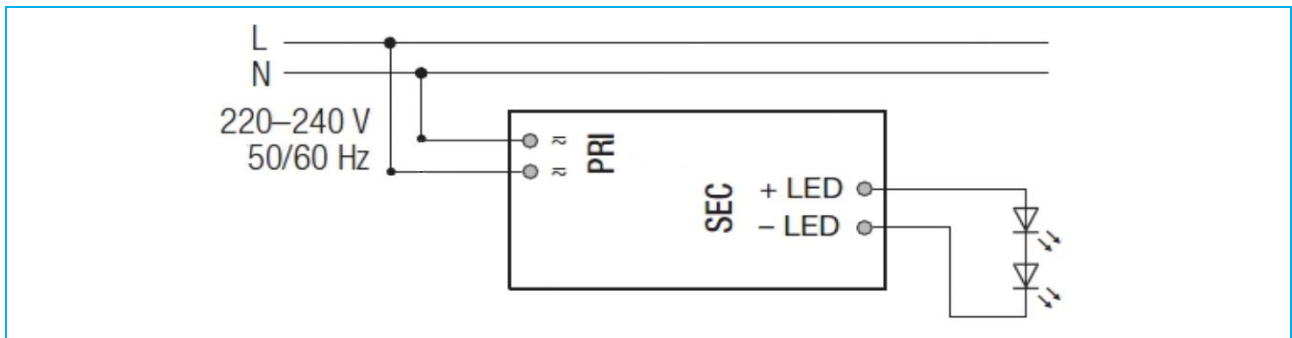

2D diagram

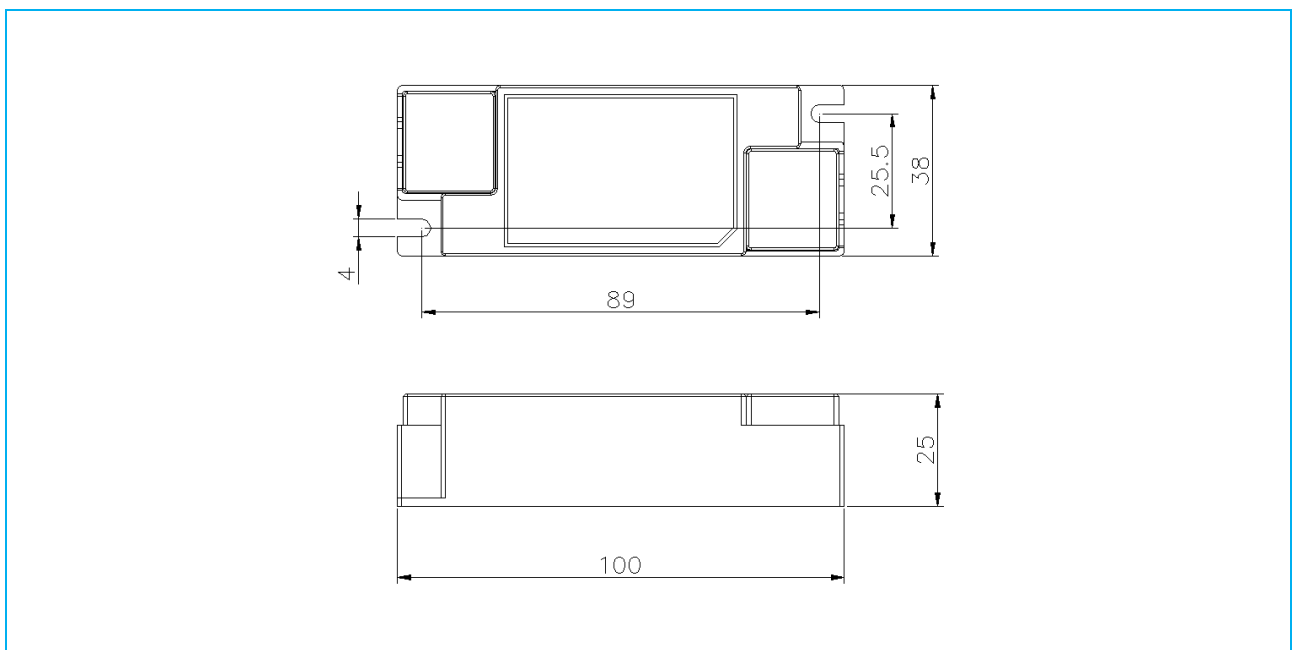

Curve for LS-9-350 TRIAC LI

9W LED Driver Constant current

LS-9-XXX TRIAC LI

Lifetime vs. Ambient Temperature Curve

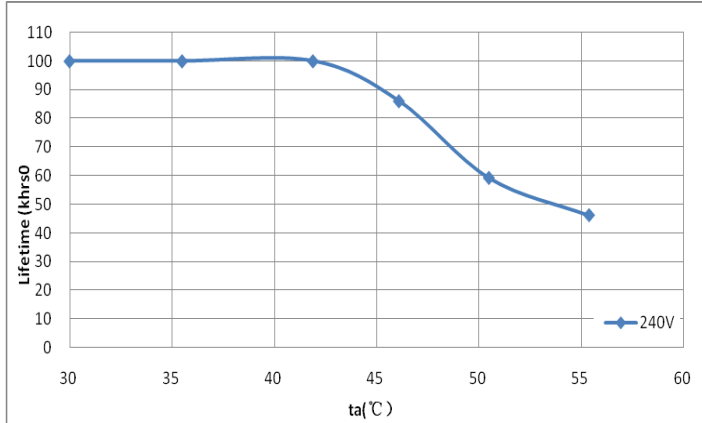

Efficiency vs. Load

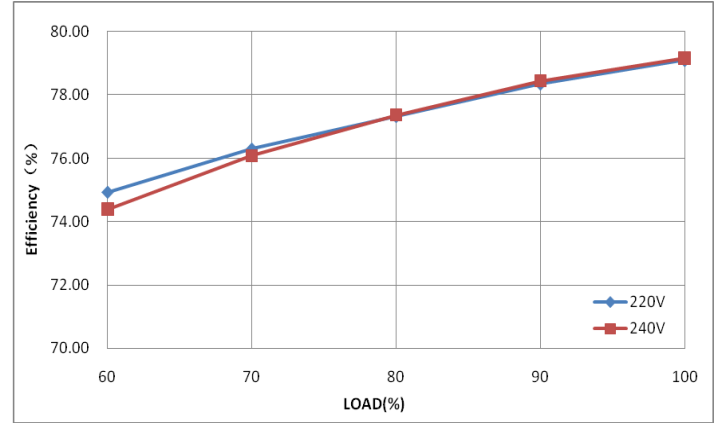

Power Factor Characteristics

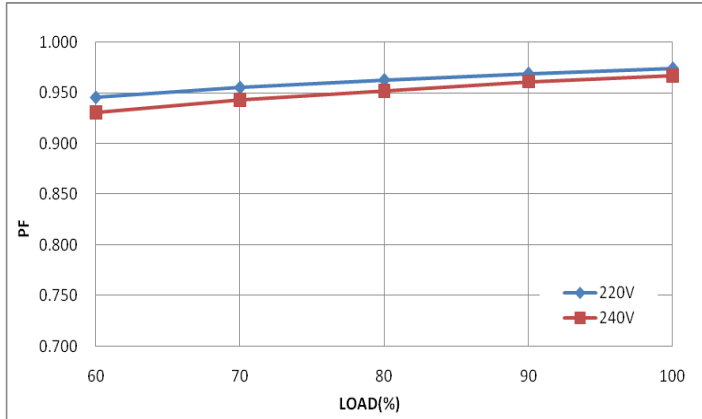

THD vs. Load

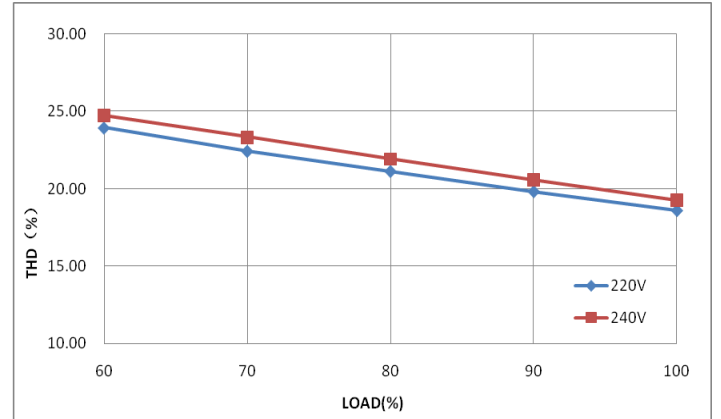

■ Operating window

